

DRESSING TABLE

Stock number: 3052-90

Thank you for purchasing this product. Please read the instructions carefully before use to ensure safe and satisfactory operation of this product.

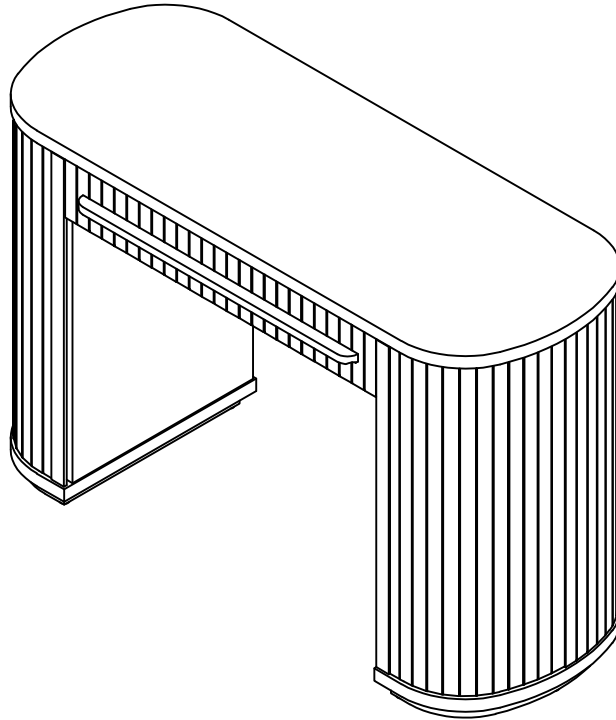

Pre-assembly preparation

Please ensure instructions are read in full before attempting to assemble this product.

Necessary Tools :

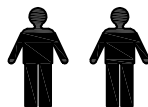

(Included)



Please check the pack contents before attempting to assemble this product. A full checklist of components is given in this leaflet. If any components are missing, please contact the retailer from whom you bought this product.

This product takes approximately **30 MINUTES** to assemble with **2 PEOPLE**.

All assembly should be performed on a flat, stable, clean and soft surface.

This product is **HEAVY**, it should be assembled as near as possible to the point of use. **TAKE CARE WHEN LIFTING** to avoid personal injury and (or) damage to the product

The fitting pack contains **SMALL ITEMS** which should be **KEPT AWAY FROM YOUNG CHILDREN**.

IMPORTANT: Retain these instructions for future reference.

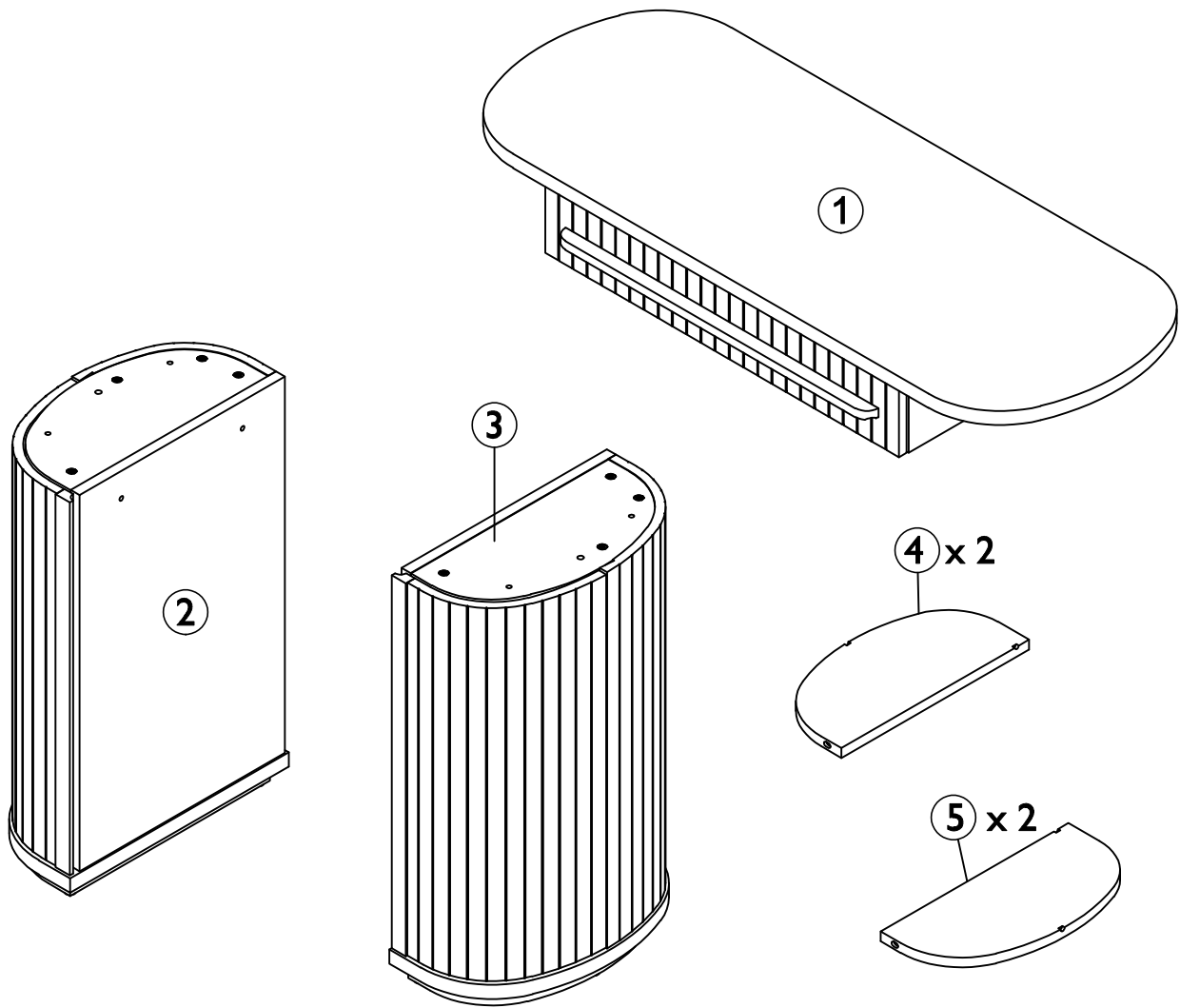

Fittings and parts checklist

Item	Description	Qty.	Item	Description	Qty.
1	Top frame	x 1	4	Removable shelf left	x 2
2	Side frame left	x 1	5	Removable shelf right	x 2
3	Side frame right	x 1			
A	Dowel Ø10 x 30mm	x 2	C	Allen key M4 x 30 x 110mm	x 1
B	Hex head bolt M8x30mm	x 8	D	Shelf pin	x 12

Step By Step Assembly Instructions

- Step 1**
- 1.1 : Lay all parts on a flat, stable, clean and soft surface.
- 1.2 : Insert 2x wooden dowels (A) into the pre-drilled holes on side frame left (2) & side frame right (3) as shown.

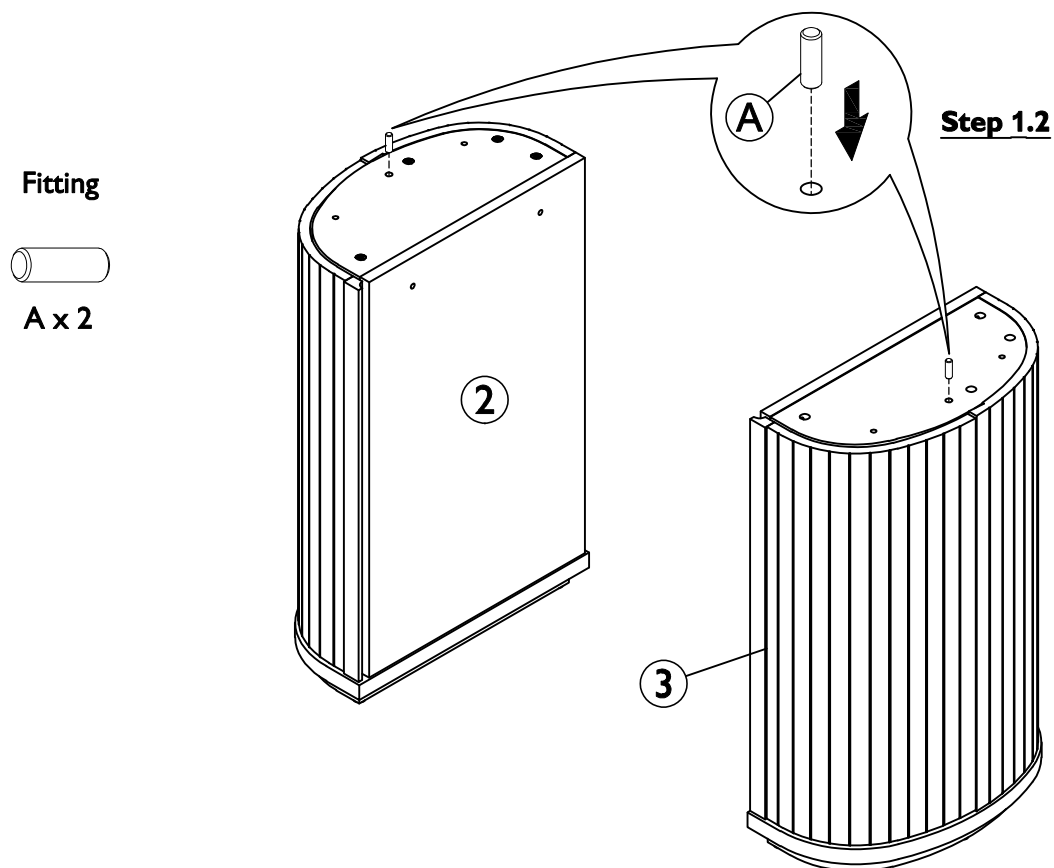

- Step 2**
- Pull out the drawers as shown. (For removal, extend the runner all the way out. Unlock by hold the handle and pull out the drawer).

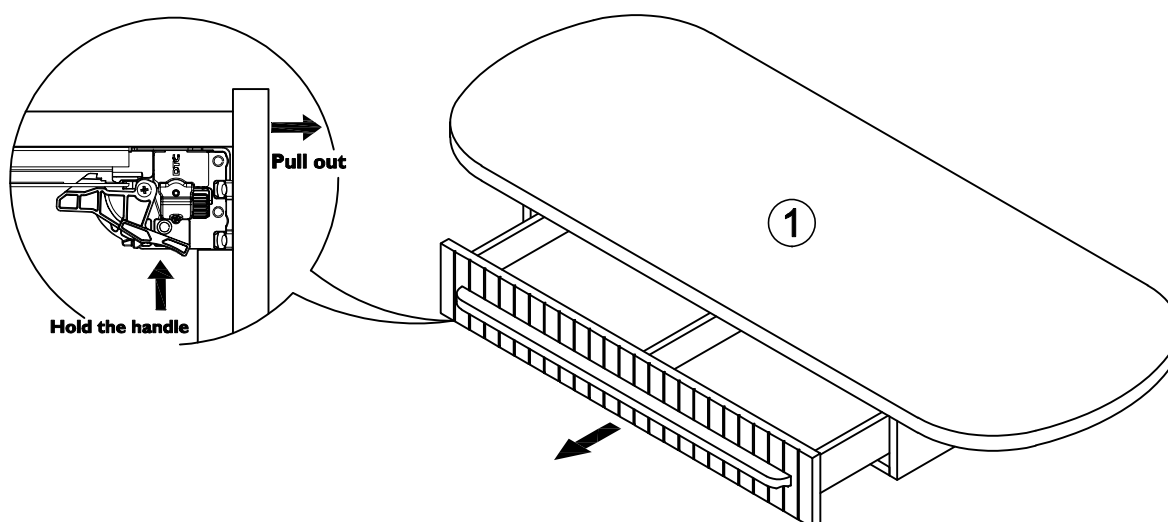

Step By Step Assembly Instructions

Step 3 Attach top frame (1) onto side frame left (2) & side frame right (3) as shown. Ensure wooden dowels (A) are aligned correctly with the pre-drilled holes on top frame (1) before attaching.

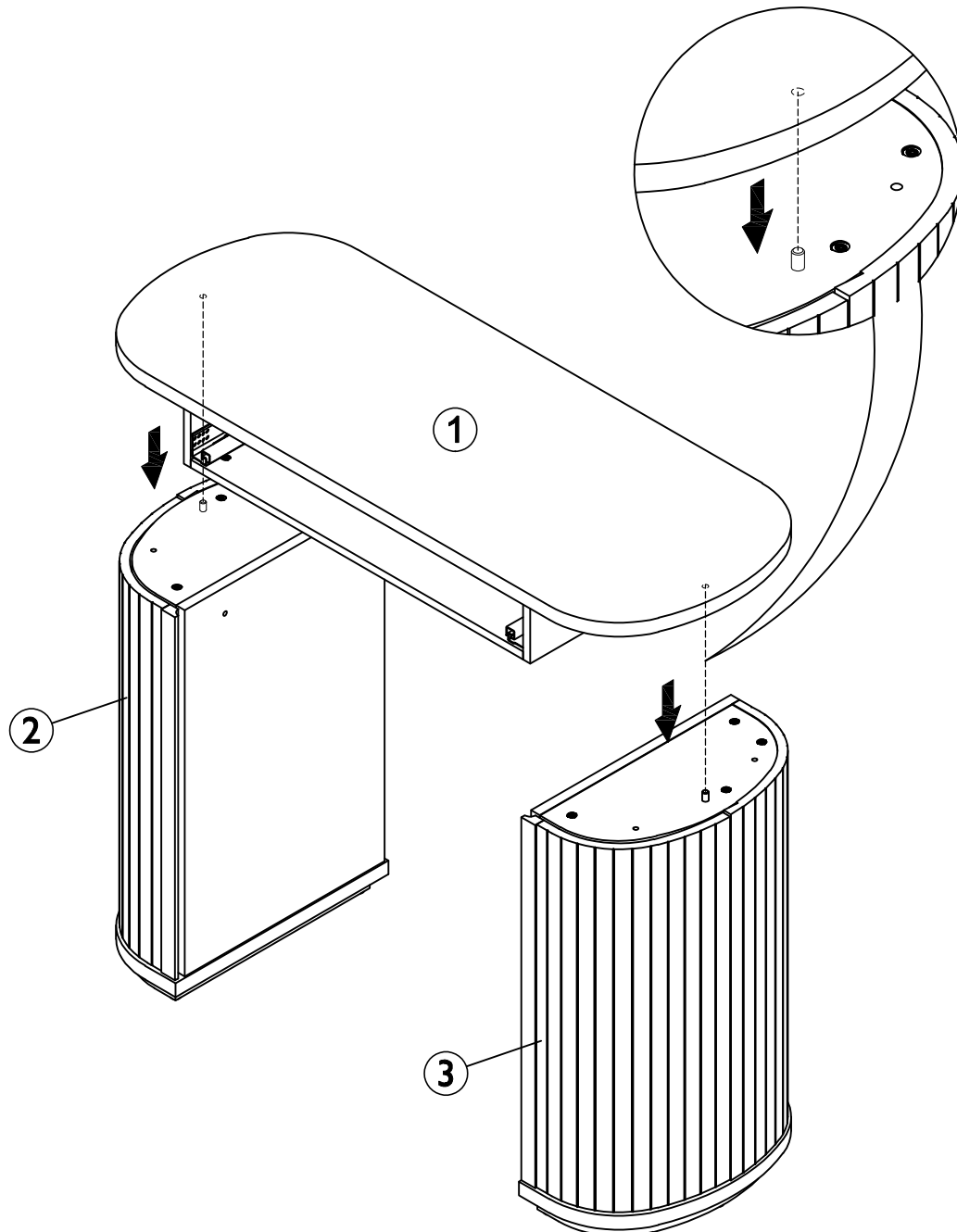

Step By Step Assembly Instructions

- Step 4**
- 4.1 : Open the doors of the side frame left (2) & side frame right (3) as shown.
 - 4.2 : Secure part (2) to part (1) by using 4x hex head bolts (B) as shown. Use allen key (C) to turn fittings (B) clockwise to fix.
 - 4.3 : Secure part (3) to part (1) by using 4x hex head bolts (B) as shown. Use allen key (C) to turn fittings (B) clockwise to fix.

Fitting

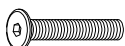

B x 8

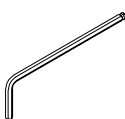

C x 1

Step 4.1

Step 4.2 & 4.3

Step 4.1

Step 4.2 & 4.3

Step By Step Assembly Instructions

- Step 5** 5.1 : Screw 12x shelf pins (D) into the inset fittings in side frame left (2) & side frame right (3) as shown.
- 5.2 : Slide parts (4) & (5) into the side frame left (2) & side frame right (3). Ensure the notches on shelves are facing down, then lower them onto the pins of shelf pins (D) as shown.

Fitting



D x 12

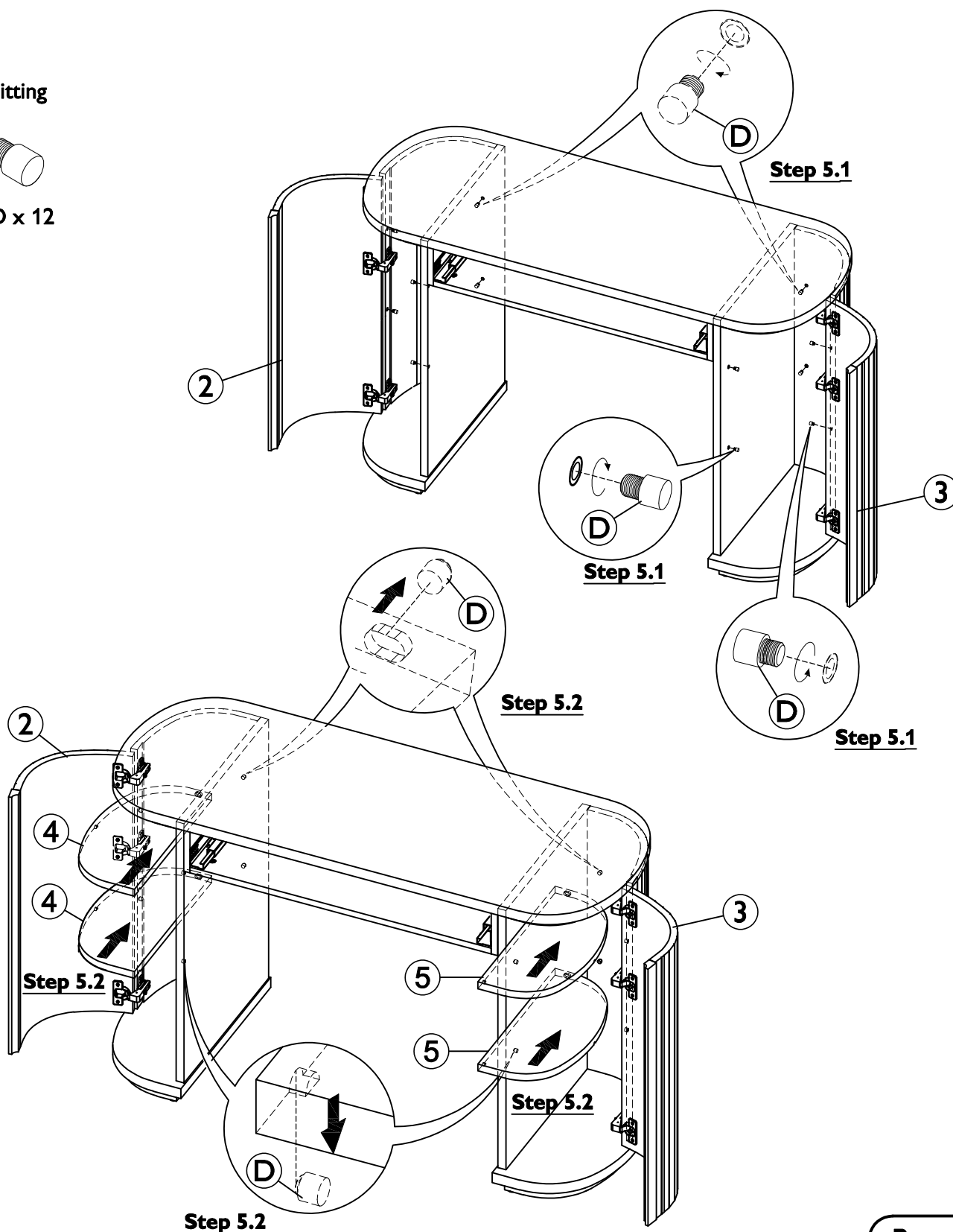

Step By Step Assembly Instructions

- Step 6** Insert the drawers into the unit as shown. (Lay the drawer bottom onto the slide then push the drawer into the cabinet)

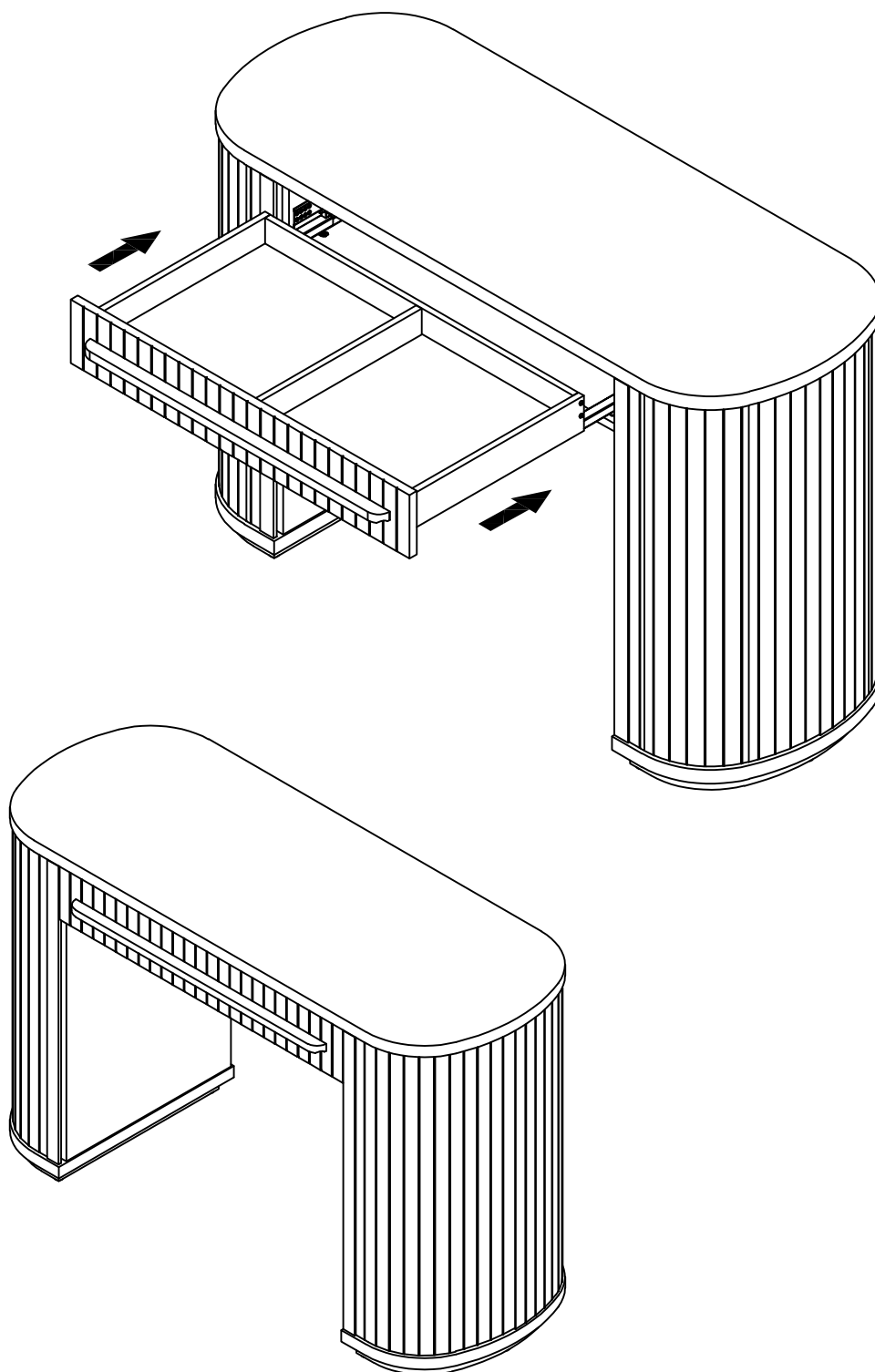

Assembly is complete

HINGE ADJUSTMENT INSTRUCTIONS

LATERAL ADJUSTMENT

by screw adjustment.

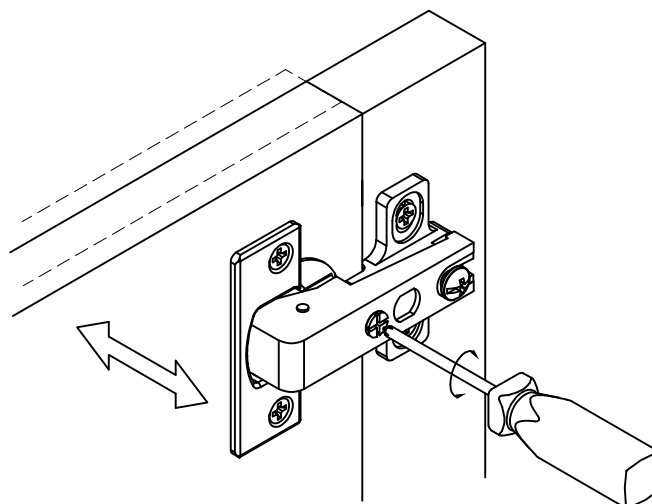

FRONT-TO-BACK

by slackening and retightening
the hinge-arm mounting screw.

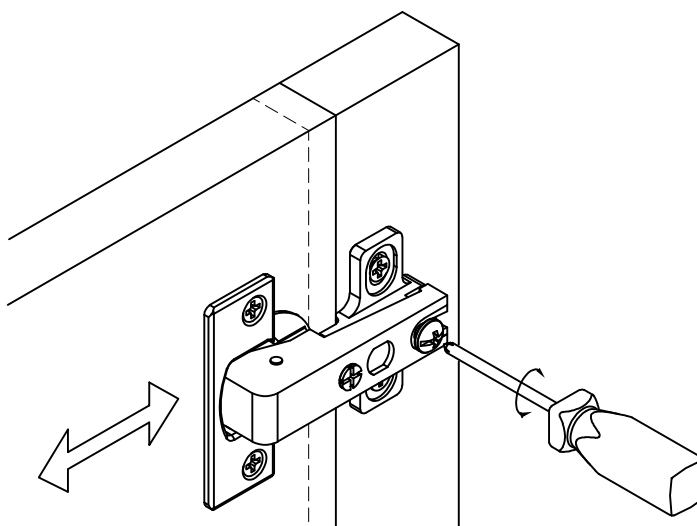

VERTICAL ADJUSTMENT

via slots on mounting
plate by slackening and
retightening the screws
on mounting plate

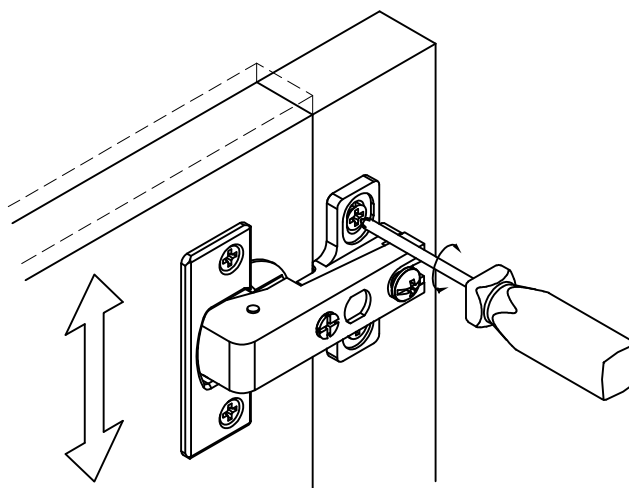

UNDERMOUNT DRAWER GLIDE ADJUSTMENT INSTRUCTION

ASSEMBLE

Lay the drawer bottom onto the slide then push the drawer into the cabinet

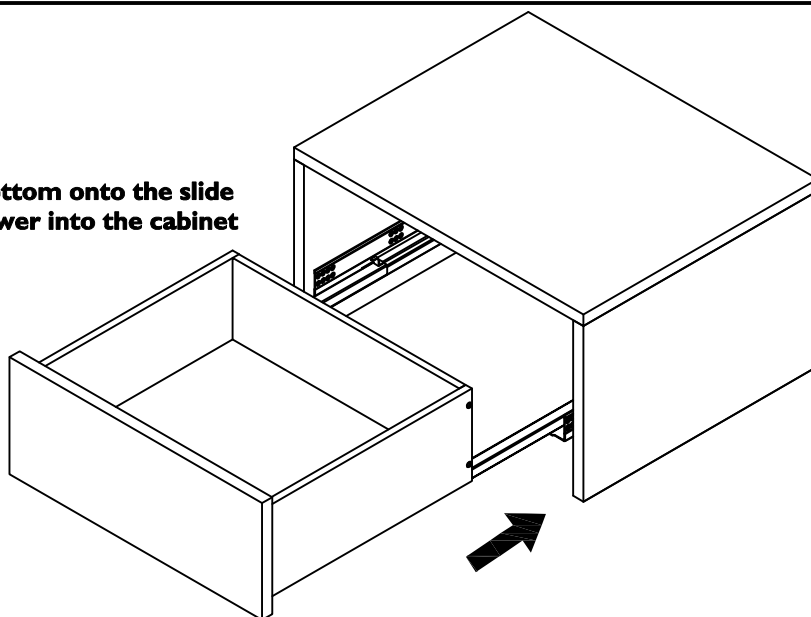

HEIGHT ADJUSTMENT

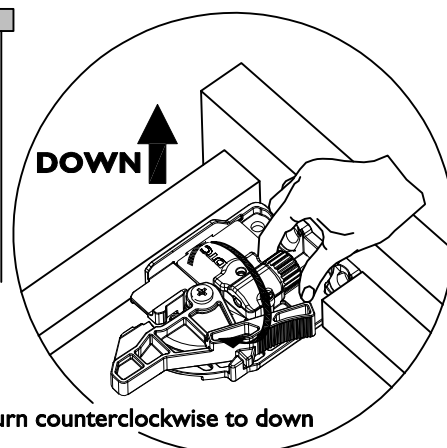
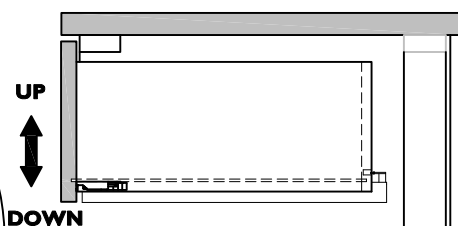
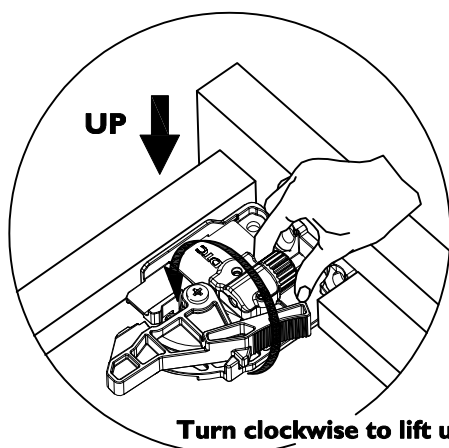

REMOVE

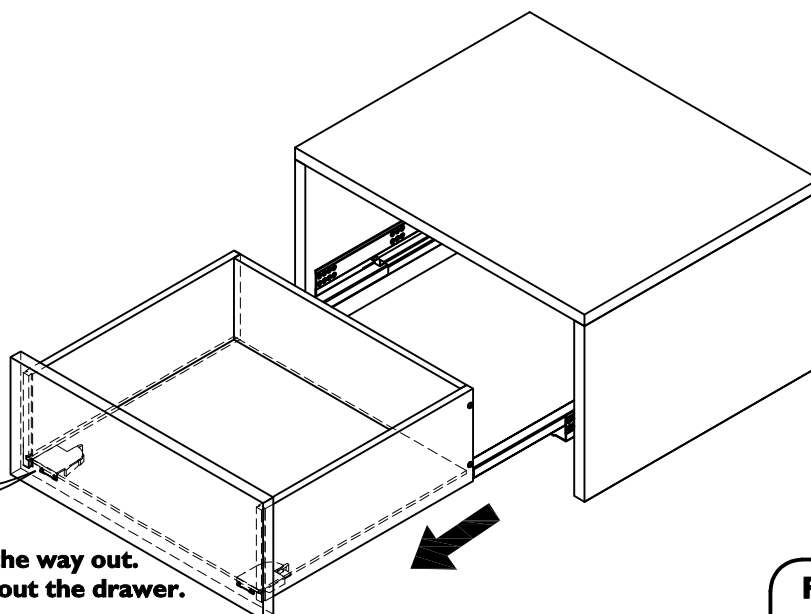
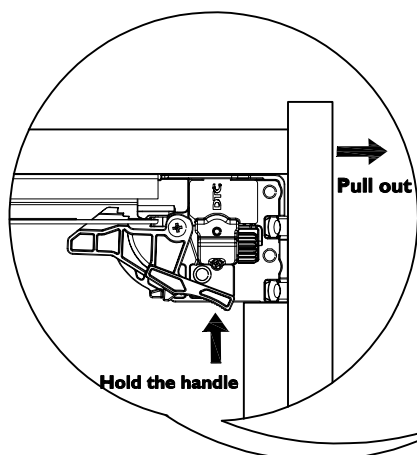

For removal, extend the runner all the way out. Unlock by hold the handle and pull out the drawer.