

OPEN ENTERTAINMENT UNIT

Stock number: 3049-33

Thank you for purchasing this product. Please read the instructions carefully before use to ensure safe and satisfactory operation of this product.

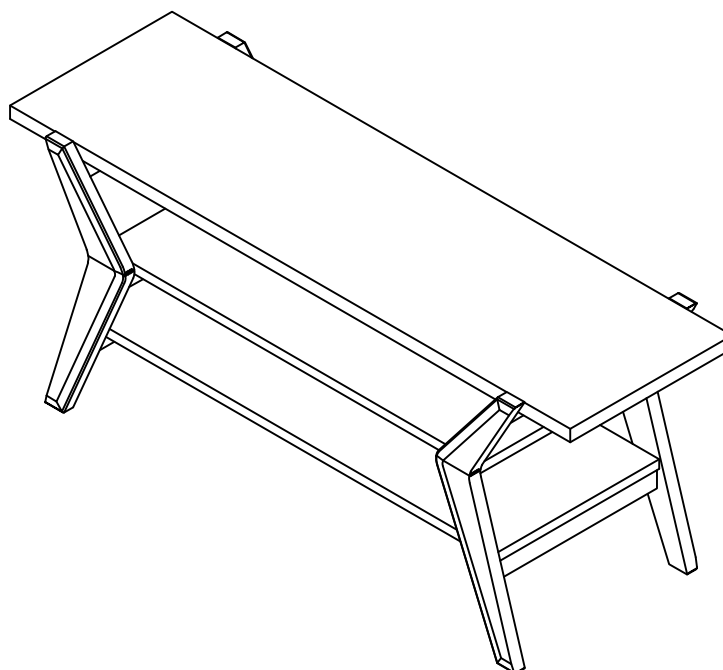

Pre-assembly preparation

Please ensure instructions are read in full before attempting to assemble this product.

Necessary Tools : Pozi screwdriver

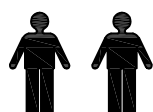

Pz 2 or Pz 3

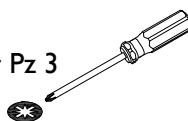

(Included)



Please check the pack contents before attempting to assemble this product. A full checklist of components is given in this leaflet. If any components are missing, please contact the retailer from whom you bought this product.

This product takes approximately **30 MINUTES** to assemble with **2 PEOPLE**.

All assembly should be performed on a flat, stable, clean and soft surface.

This product is **HEAVY**, it should be assembled as near as possible to the point of use. **TAKE CARE WHEN LIFTING** to avoid personal injury and (or) damage to the product

The fitting pack contains **SMALL ITEMS** which should be **KEPT AWAY FROM YOUNG CHILDREN**.

IMPORTANT: Retain these instructions for future reference.

Page : 1

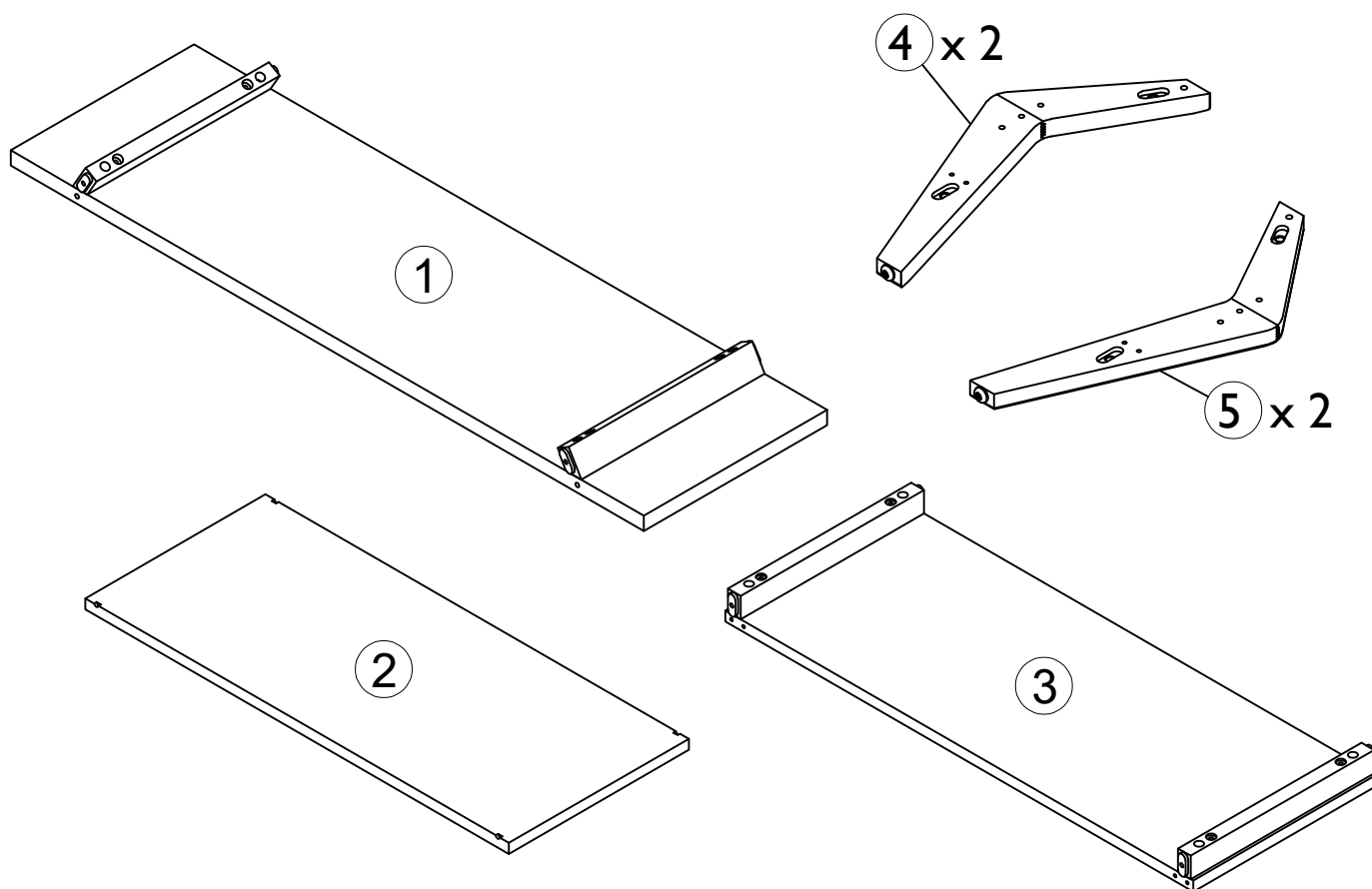

Fittings and parts checklist

Item	Description	Qty.	Item	Description	Qty.
1	Top frame	x 1	4	Leg A	x 2
2	Adjustable shelf	x 1	5	Leg B	x 2
3	Shelf frame	x 1			
A	Wooden dowel Ø8x30mm	x 4	E	Housing Ø15x13.5mm	x 8
B	Wooden dowel Ø6x30mm	x 8	F	Grub screw M8x8mm	x 8
C	Steel dowel Ø7x52mm	x 8	G	Allen key M4x30x110mm	x 1
D	Shelf pin	x 4			

Step By Step Assembly Instructions

- Step 1**
- 1.1 : Lay all parts on a flat, stable, clean and soft surface.
 - 1.2 : Insert 4x dowels (A) into the pre-drilled holes on top frame (1) as shown.
 - 1.3 : Insert 8x dowels (B) into the pre-drilled holes on shelf frame (3) as shown.

Fitting

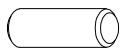

A x 4



B x 8

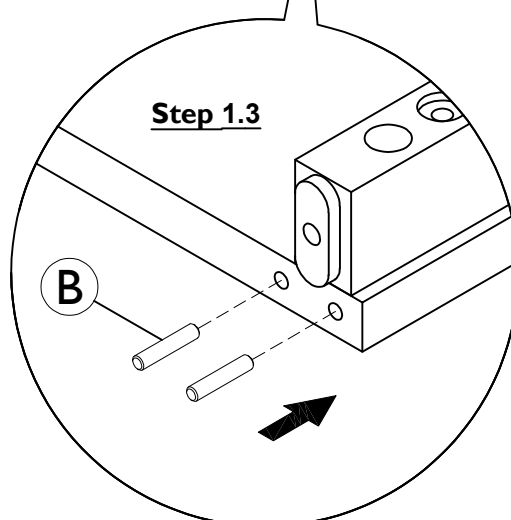
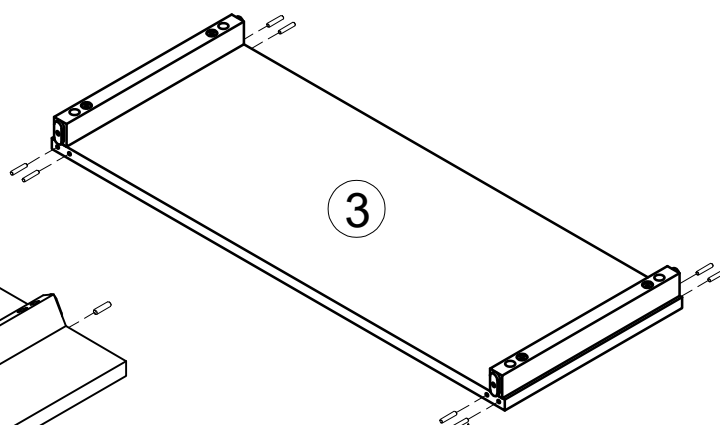
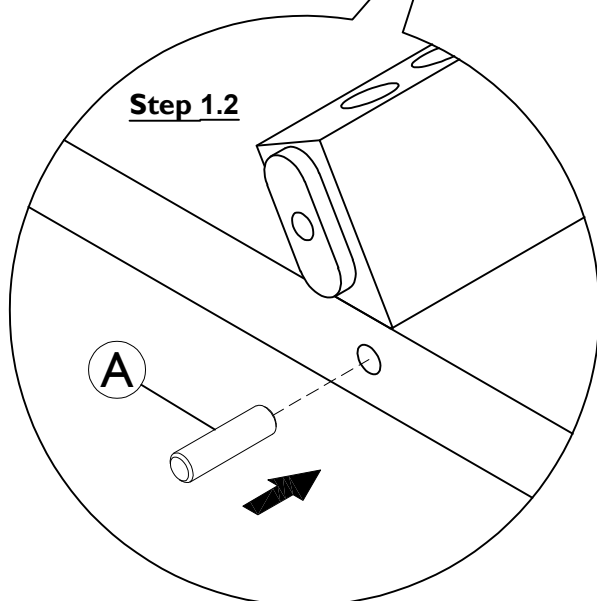
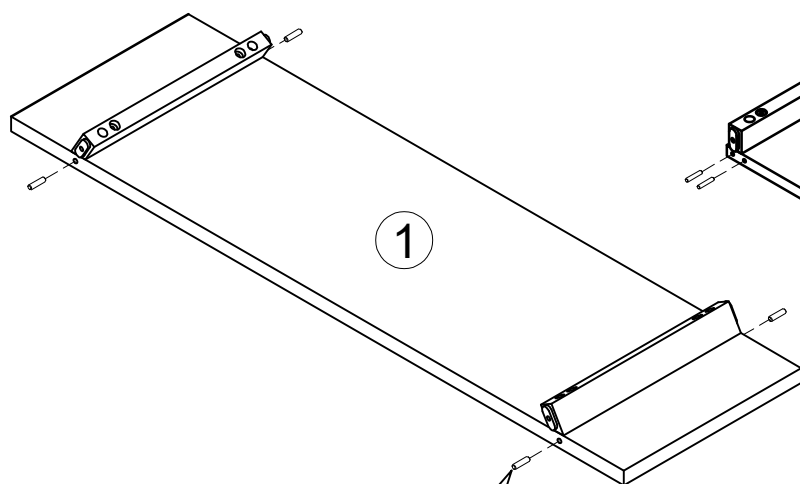

Step By Step Assembly Instructions

Step 2 2.1 : Attach 8x steel dowels (C) into legs A (4) & legs B (5) by screwing fittings (C) into the inset fittings that are located on parts (4) & (5) as shown. Use a pozi screwdriver to turn fittings (C) clockwise to fix.

2.2 : Screw 4x shelf pins (D) into the inset fittings in legs (4), (5) as shown.

Fitting



C x 8



D x 4

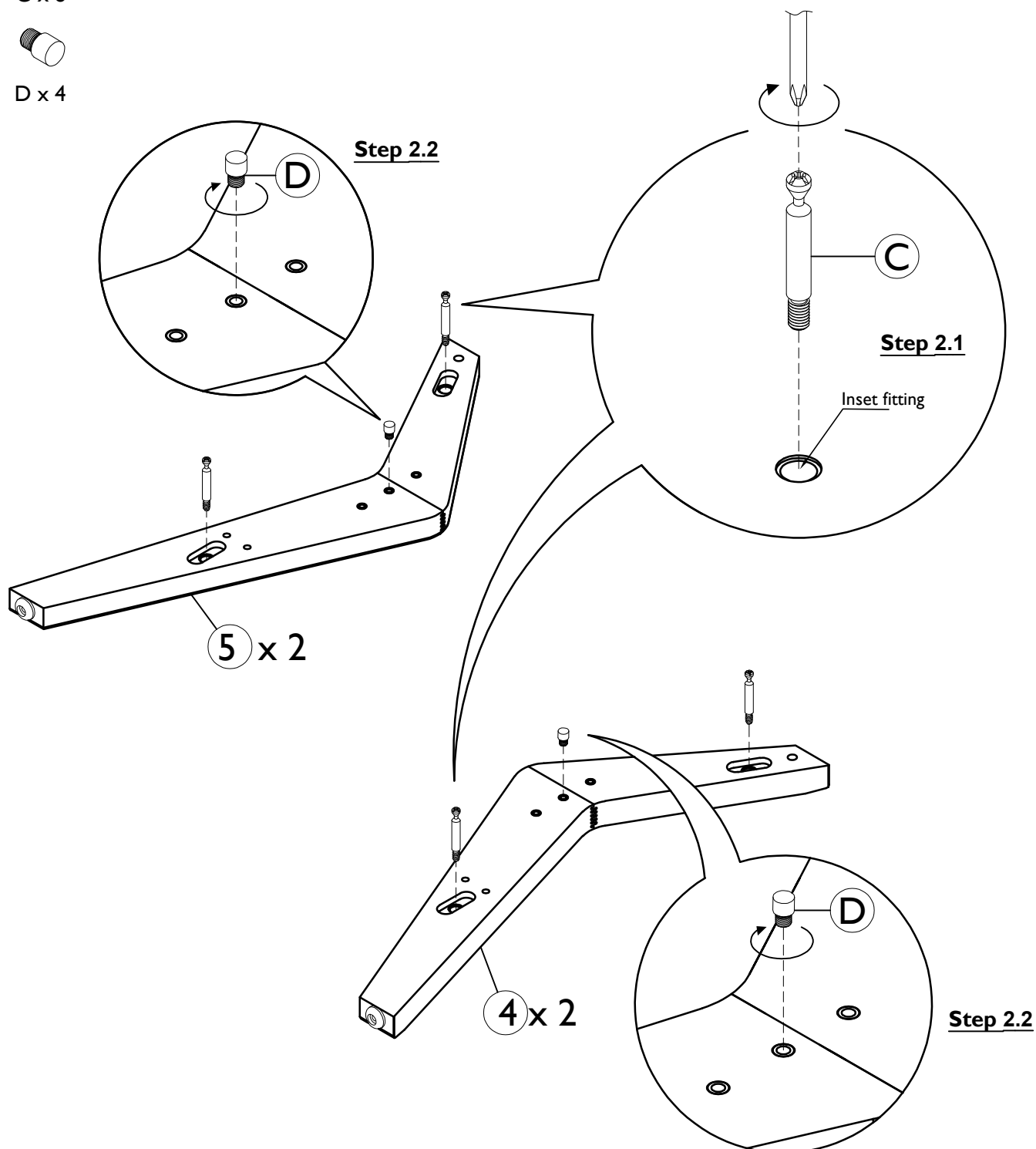

Step By Step Assembly Instructions

- Step 3**
- 3.1 : Insert 4x housings (E) into the pre-drilled holes on top frame (1) and shelf frame (3) as shown.
- 3.2 : Attach top frame (1) and shelf frame (3) onto leg A (4) & leg B (5) as shown. Ensure steel dowel (C) and wooden dowels (A), (B) are aligned correctly with the holes of mating parts before attaching.

Fitting



E x 4

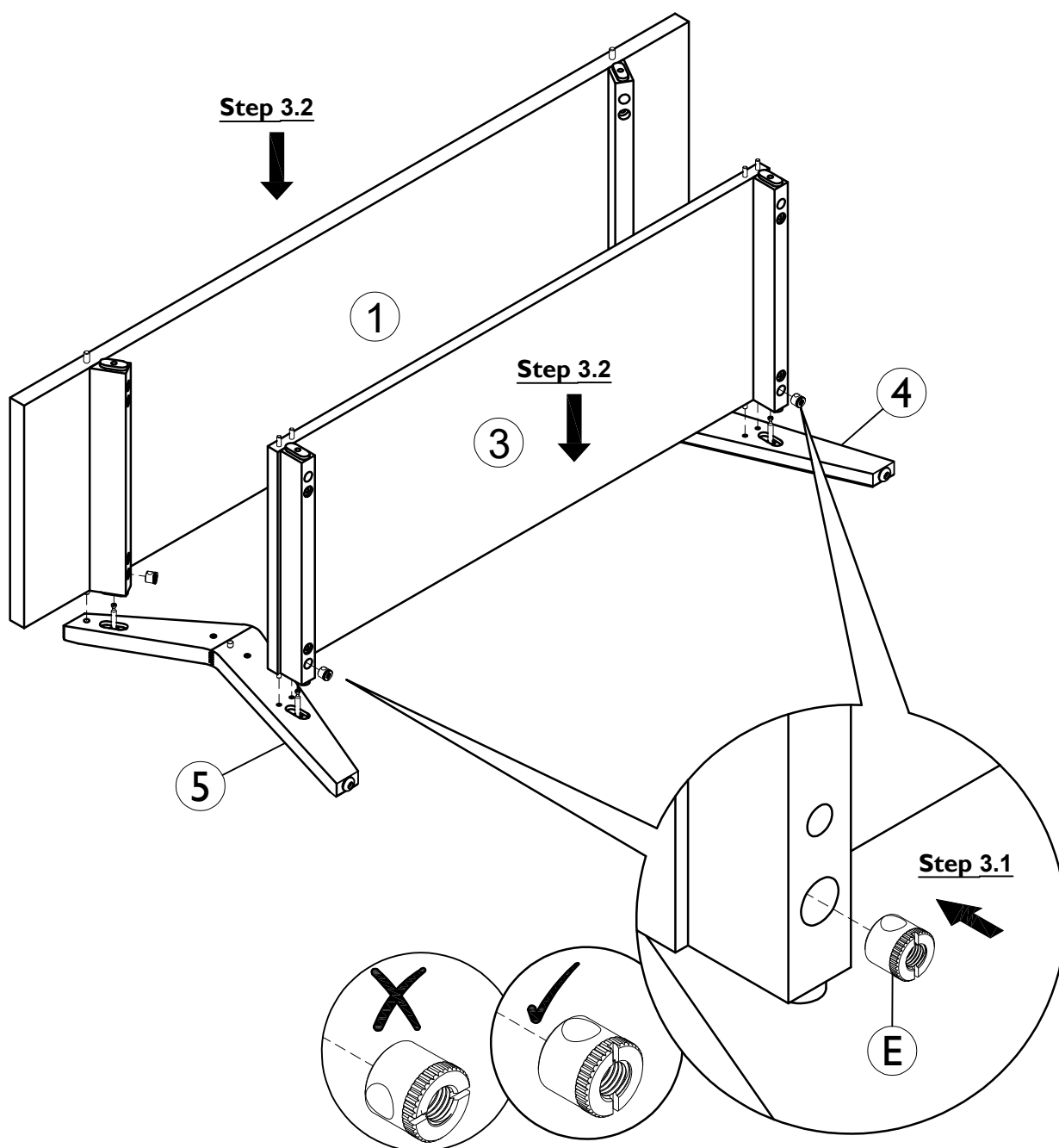

Step By Step Assembly Instructions

Step 4 Secure parts (1), (3) to parts (4) & (5) using 4x grub screws (F) as shown. Use an allen key (G) to turn fittings (F) clockwise to fix.

Fitting



F x 4



G x 1

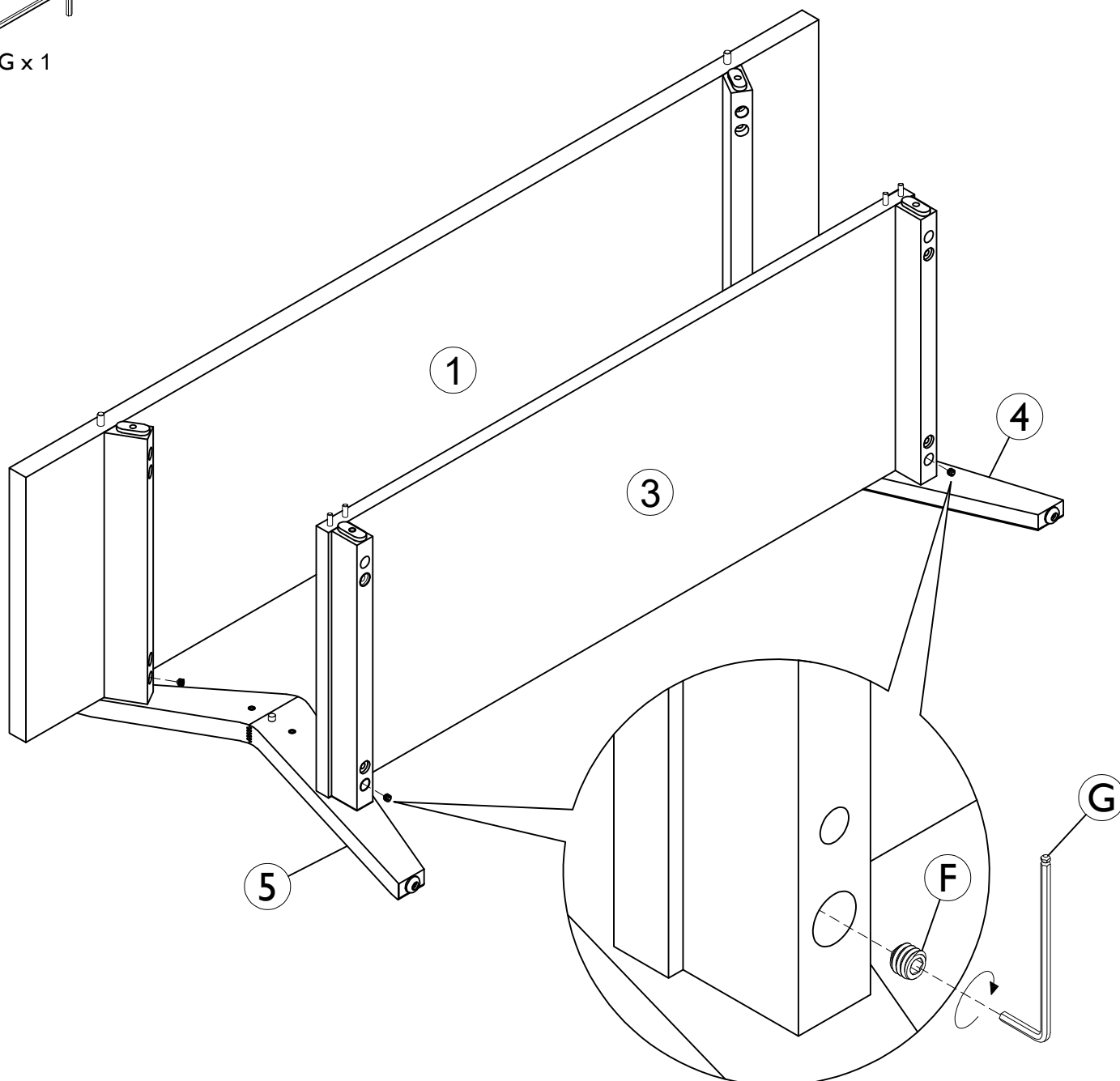

Step By Step Assembly Instructions

Step 5

5.1 : Attach 4x housings (E) into the pre-drilled holes on top frame (1) and shelf frame (3) as shown.

5.2 : Attach leg A (4) & leg B (5) to the structure assembled in **Step 4** as shown. Ensure steel dowel (C) and wooden dowels (A), (B) are aligned correctly with the holes of mating parts before attaching.

Fitting



E x 4

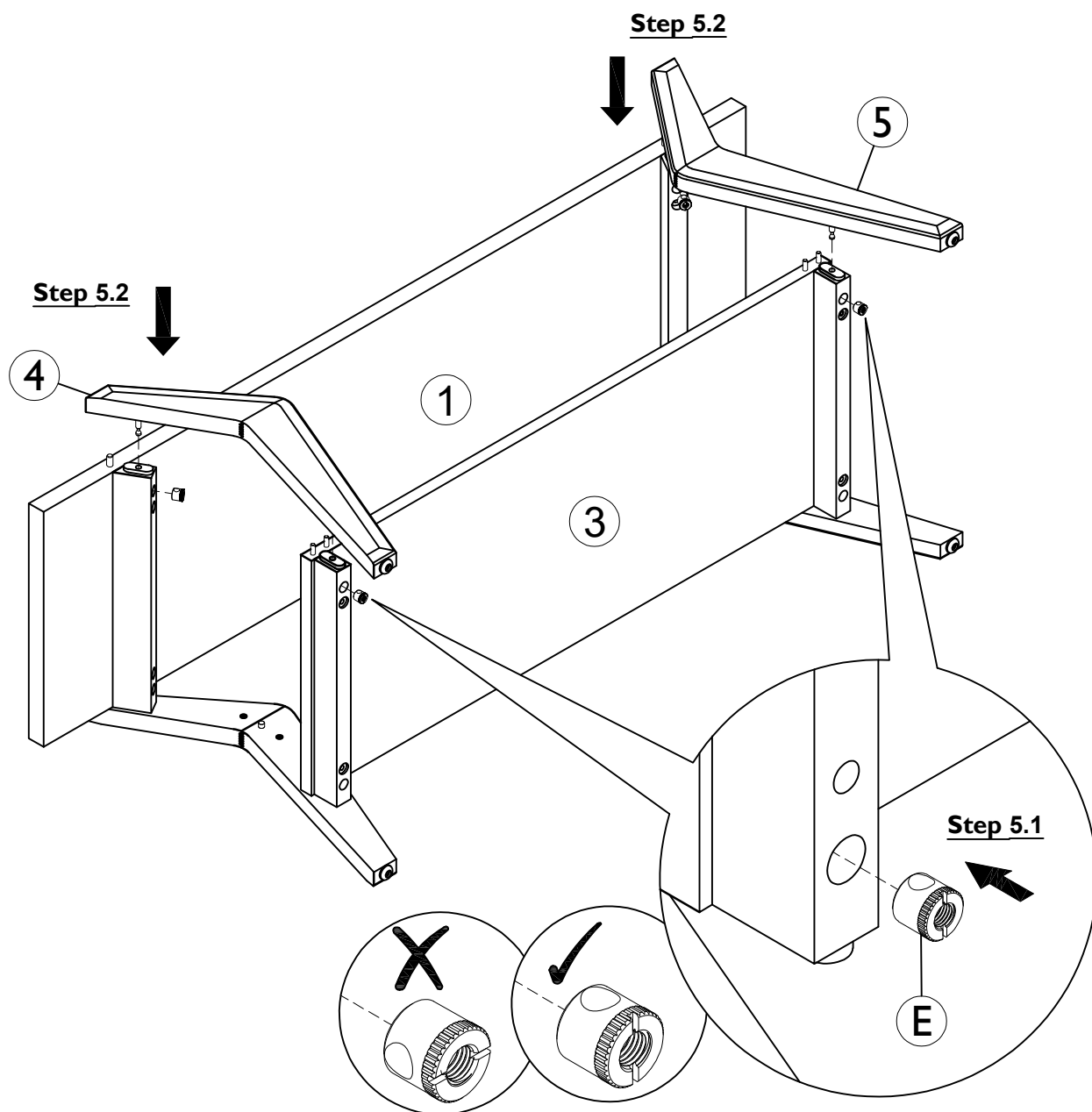

Step By Step Assembly Instructions

- Step 6** 6.1 : Secure parts (4) & (5) to parts (1), (3) using 4x grub screws (F) as shown. Use an allen key (G) to turn fittings (F) clockwise to fix.
6.2 : With help of assistant, carefully turn the unit up right.

Fitting



F x 4



G x 1

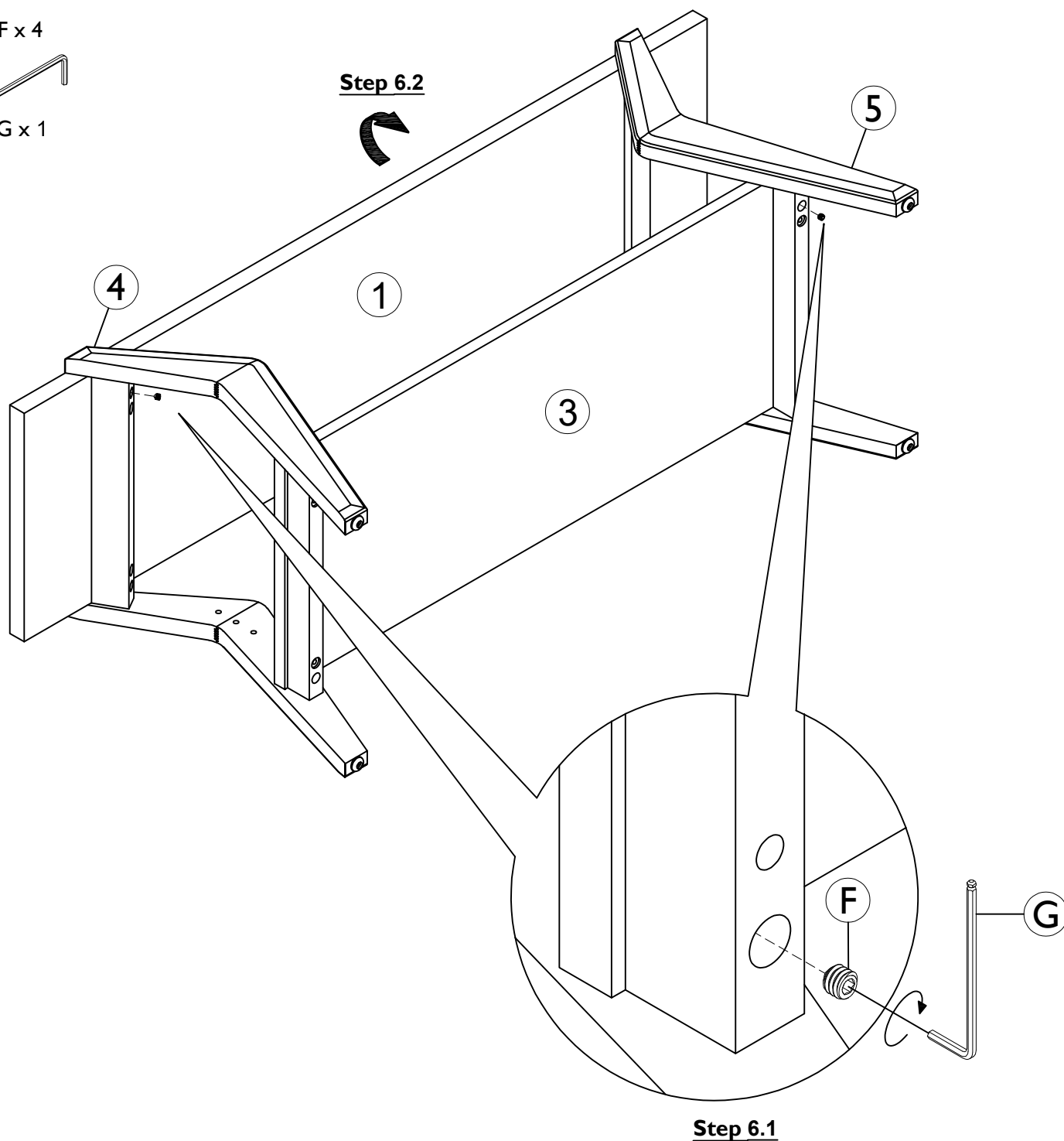

Step By Step Assembly Instructions

- Step 7**
- 7.1 : Carefull slide adjustable shelf (2) into the unit.
 - 7.2 : Lower adjustable shelf onto fittings (D).

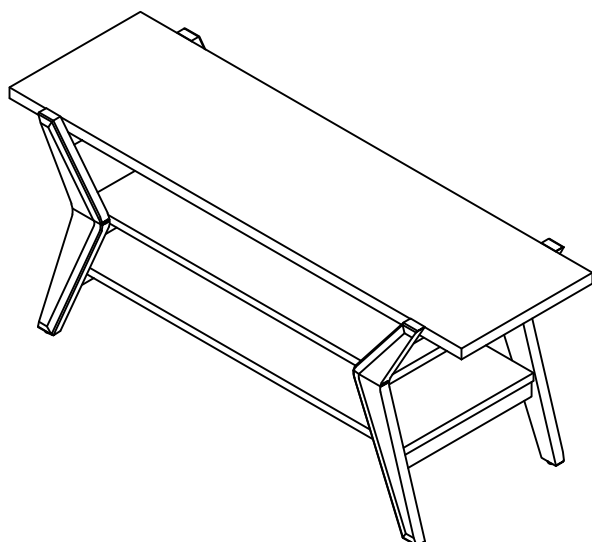
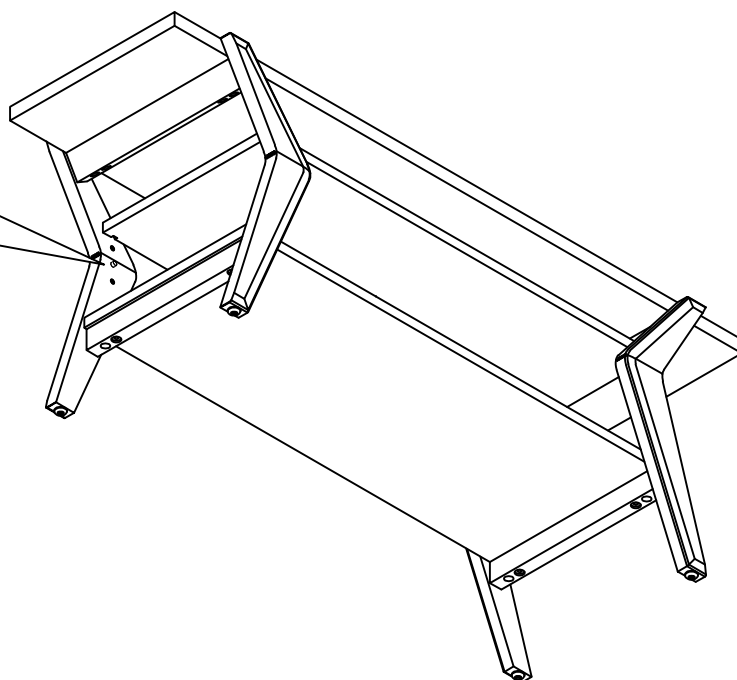
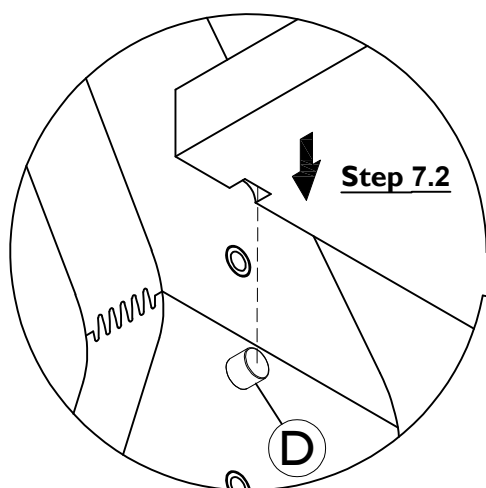
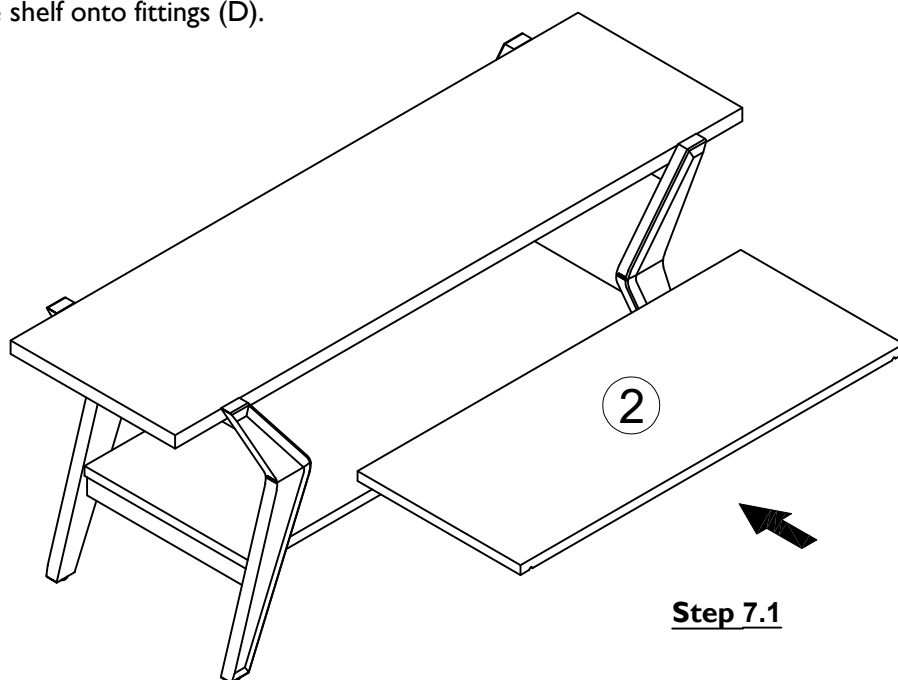

Assembly is complete