

# ENTERTAINMENT UNIT

Stock number: 3049-25

Thank you for purchasing this product. Please read the instructions carefully before use to ensure safe and satisfactory operation of this product.

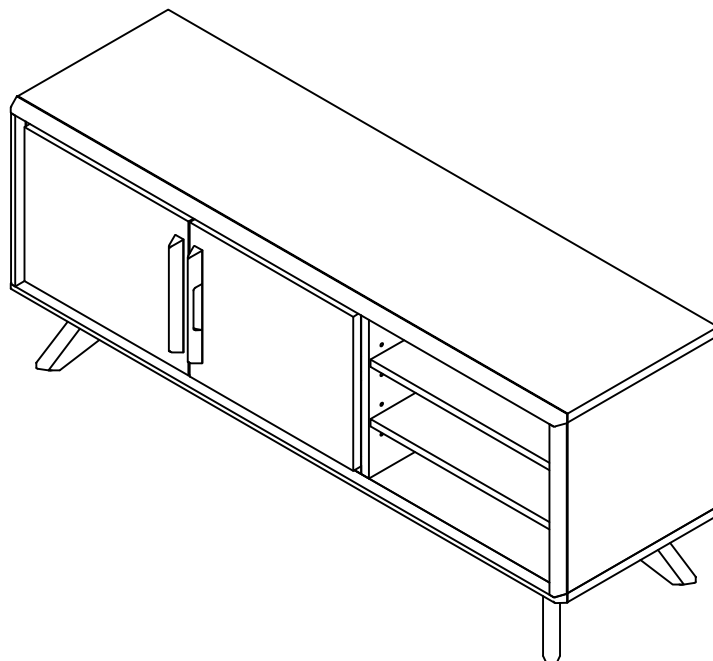

## Pre-assembly preparation

Please ensure instructions are read in full before attempting to assemble this product.

### Necessary Tools :

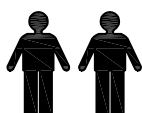

( Included )

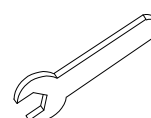

Please check the pack contents before attempting to assemble this product. A full checklist of components is given in this leaflet. If any components are missing, please contact the retailer from whom you bought this product.

This product takes approximately **30 MINUTES** to assemble with **2 PEOPLE**.

All assembly should be performed on a flat, stable, clean and soft surface.

This product is **HEAVY**, it should be assembled as near as possible to the point of use. **TAKE CARE WHEN LIFTING** to avoid personal injury and (or) damage to the product.

The fitting pack contains **SMALL ITEMS** which should be **KEPT AWAY FROM YOUNG CHILDREN**.

**IMPORTANT:** Retain these instructions for future reference.

Page : 1

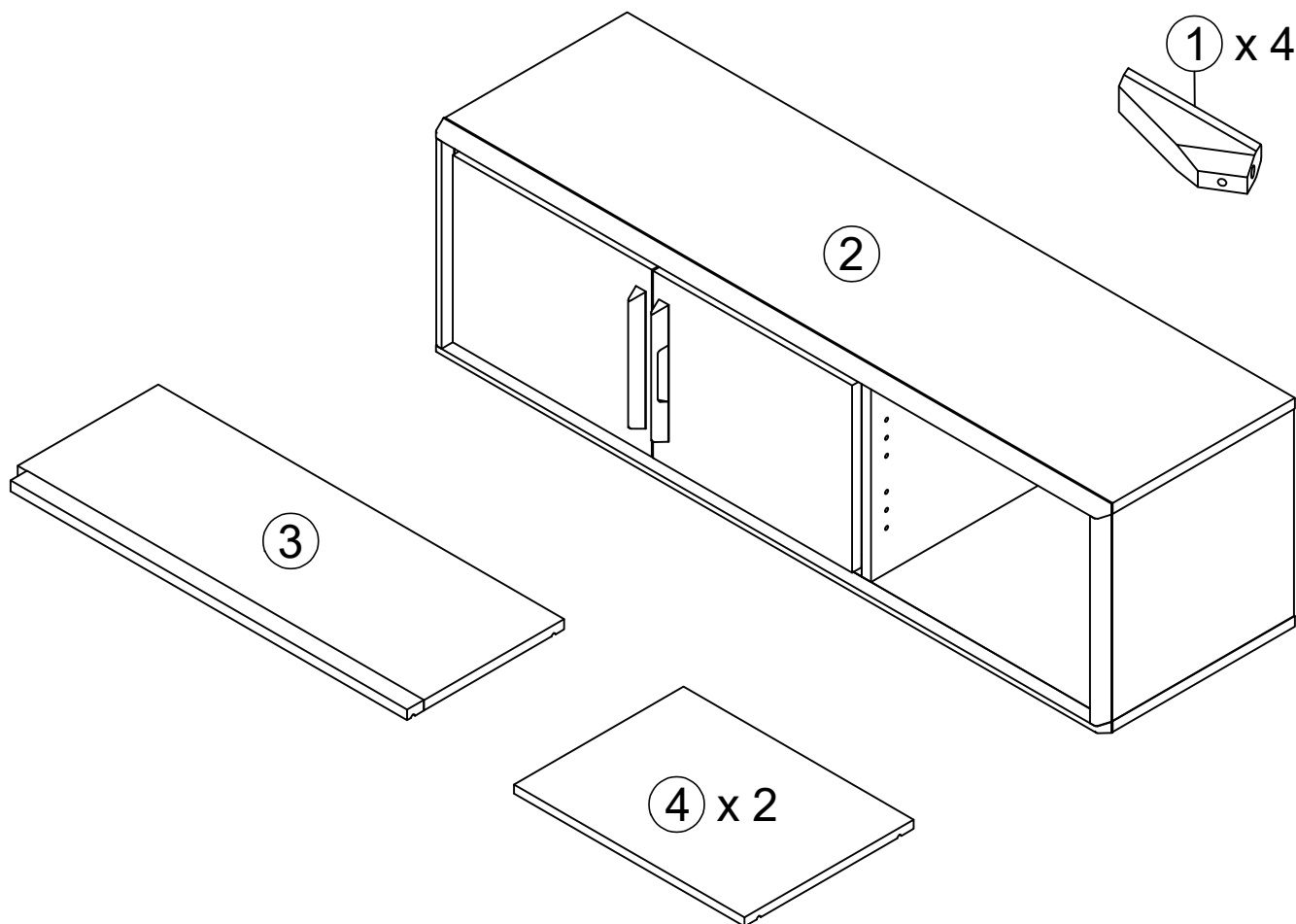

## Fittings and parts checklist

Item	Description	Qty.	Item	Description	Qty.
1	Leg	x 4	3	Adjust shelf frame A	x 1
2	Top unit	x 1	4	Adjust shelf B	x 2
A	Cross dowel Ø12 x 30mm	x 4	E	Hexagon nut M8 x 13	x 4
B	Thread bolt M8 x 80mm	x 4	F	Spanner	x 1
C	Flat washer Ø8.4 x Ø17 x 1.6mm	x 4	G	Felt Ø20 x 6mm	x 4
D	Lock washer Ø8.4 x 2mm	x 4	H	Shelf pin	x 12

# Step By Step Assembly Instructions

## Step 1

- 1.1 : Lay all parts on a flat, stable, clean and soft surface.
- 1.2 : Insert 4x cross dowels (A) into the hole on top of each legs (1) as shown. Ensure the horizontal marking on each fitting (A) is facing as shown.
- 1.3 : Screw 4x threaded bolts (B) into fittings (A) that are already concealed in legs (1) as shown. Continue to re-tighten until fittings (B) are securely fastened.

Fitting



A x 4



B x 4

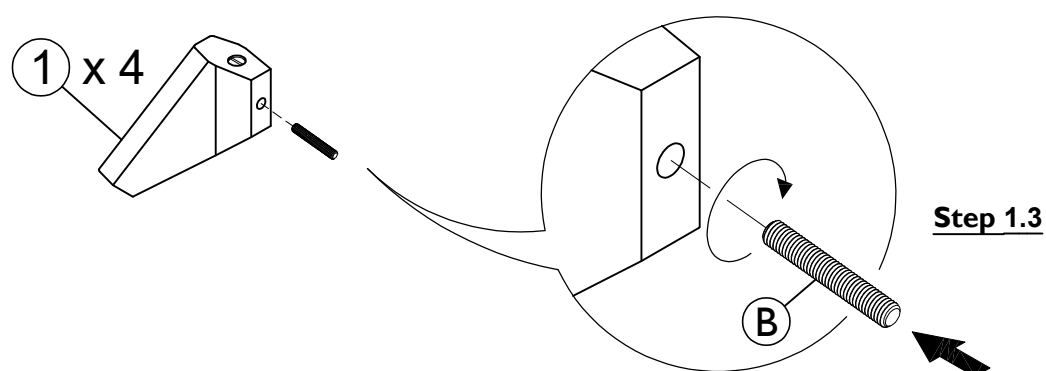
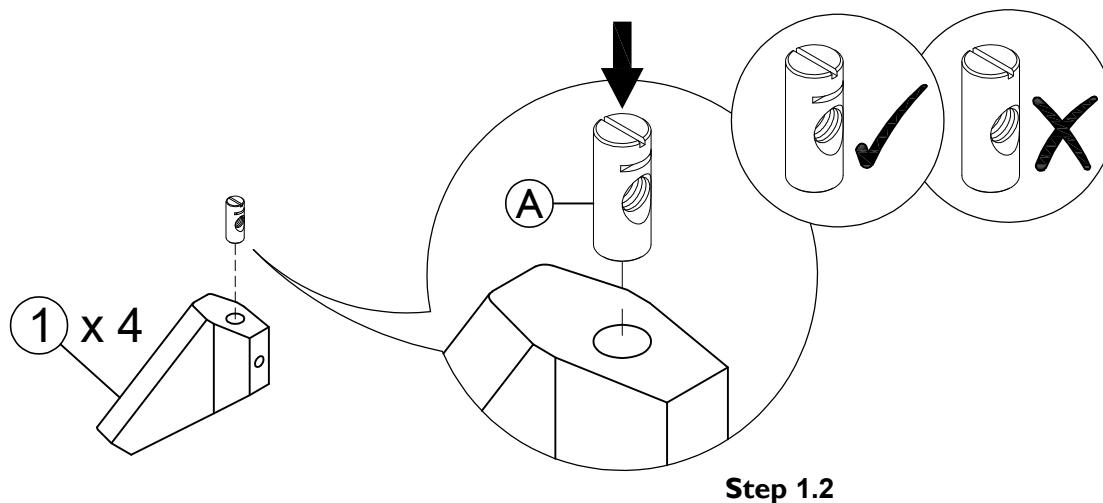

# Step By Step Assembly Instructions

## Step 2

2.1 : Attach each legs (1) to top unit (2) by inserting threaded bolts (B) into the pre-drilled hole of corner bracket as shown.

2.2 : Insert flat washer (C), lock washer (D) and hex nut (E) onto threaded bolt (B) on leg (1) and in order as shown - (C) followed by (D) followed by (E). Tighten hex nut (E) using spanner (F) as shown. Continue to re-tighten hex nut (E) until it is securely fastened.

**Repeat above procedure with the remaining the other legs.**

Fitting



C x 4



D x 4



E x 4



F x 1

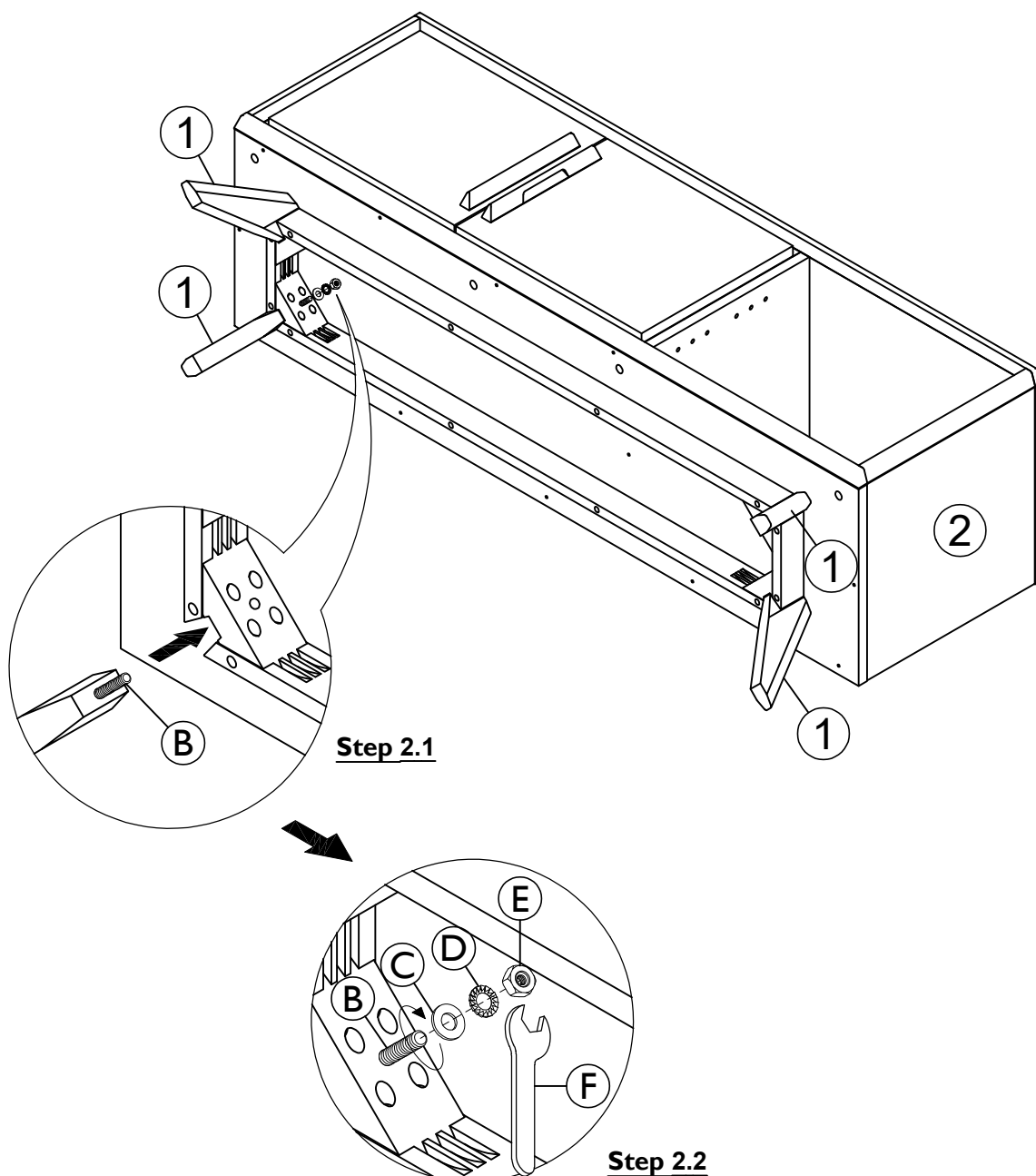

# Step By Step Assembly Instructions

- Step 3**
- 3.1 : Remove the plastic from 4x felts (G) and stick felts (G) onto under legs (1) as shown.  
3.2 : Stand the unit upright.

Fitting



G x 4

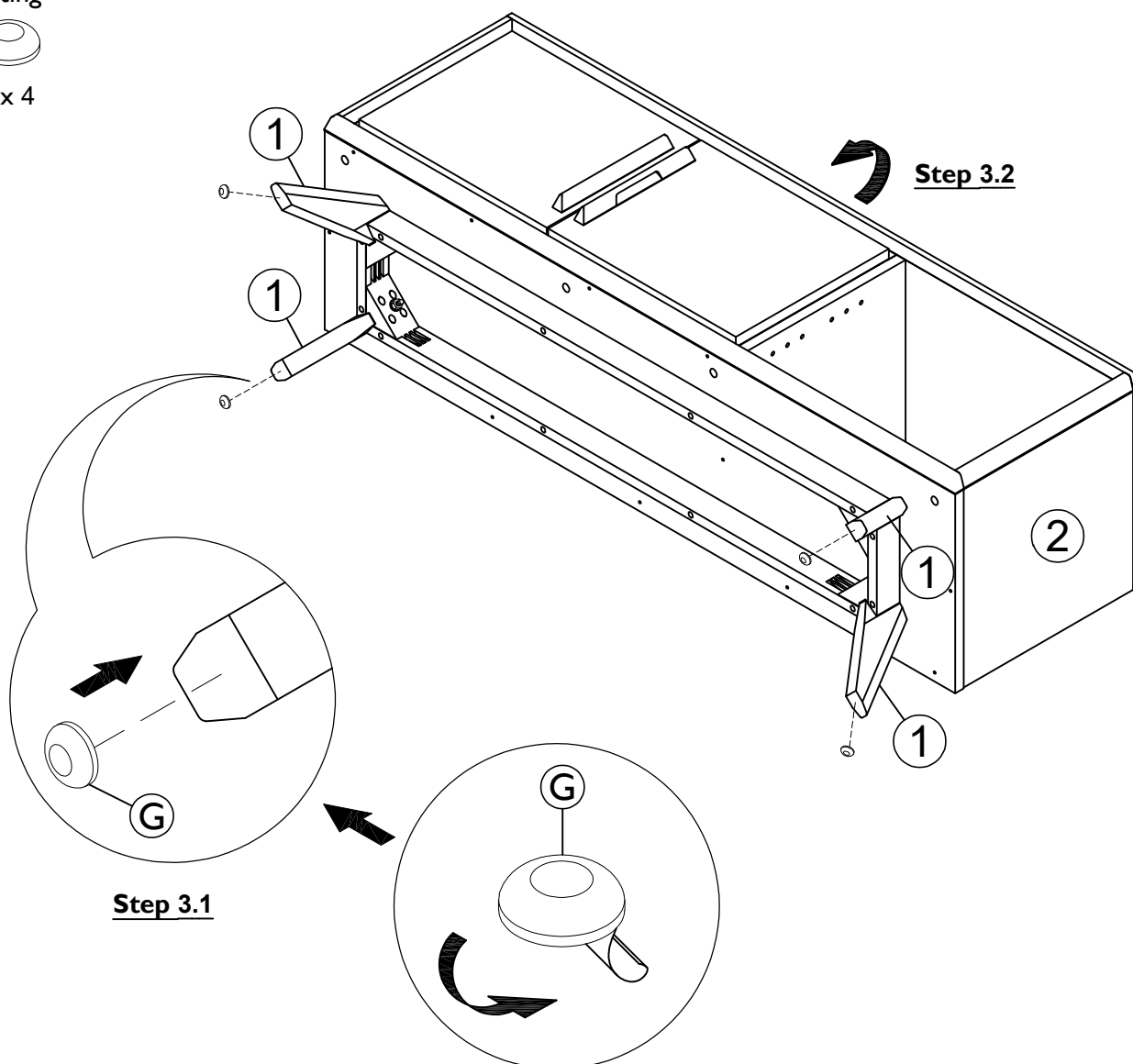

# Step By Step Assembly Instructions

## Step 4

- 4.1 : Screw 2x shelf pins (H) into the inset fittings in the unit as shown.
- 4.2 : Tilt adjustable shelf frame A (3) to a suitable angle as shown in the picture so as to slide them in.
- 4.3 : Slide part (3) into the unit. Ensure the notches on shelf are facing down, then place them onto the pins of shelf pins (H) as shown.
- 4.4 : Lift up right side of adjustable shelf frame A (3).
- 4.5 : Screw 2x shelf pins (H) into the inset fittings in partition of the unit as shown.
- 4.6 : Lower adjustable shelf frame A (3) onto the pins of shelf pins (H) as shown.

Fitting



H x 4

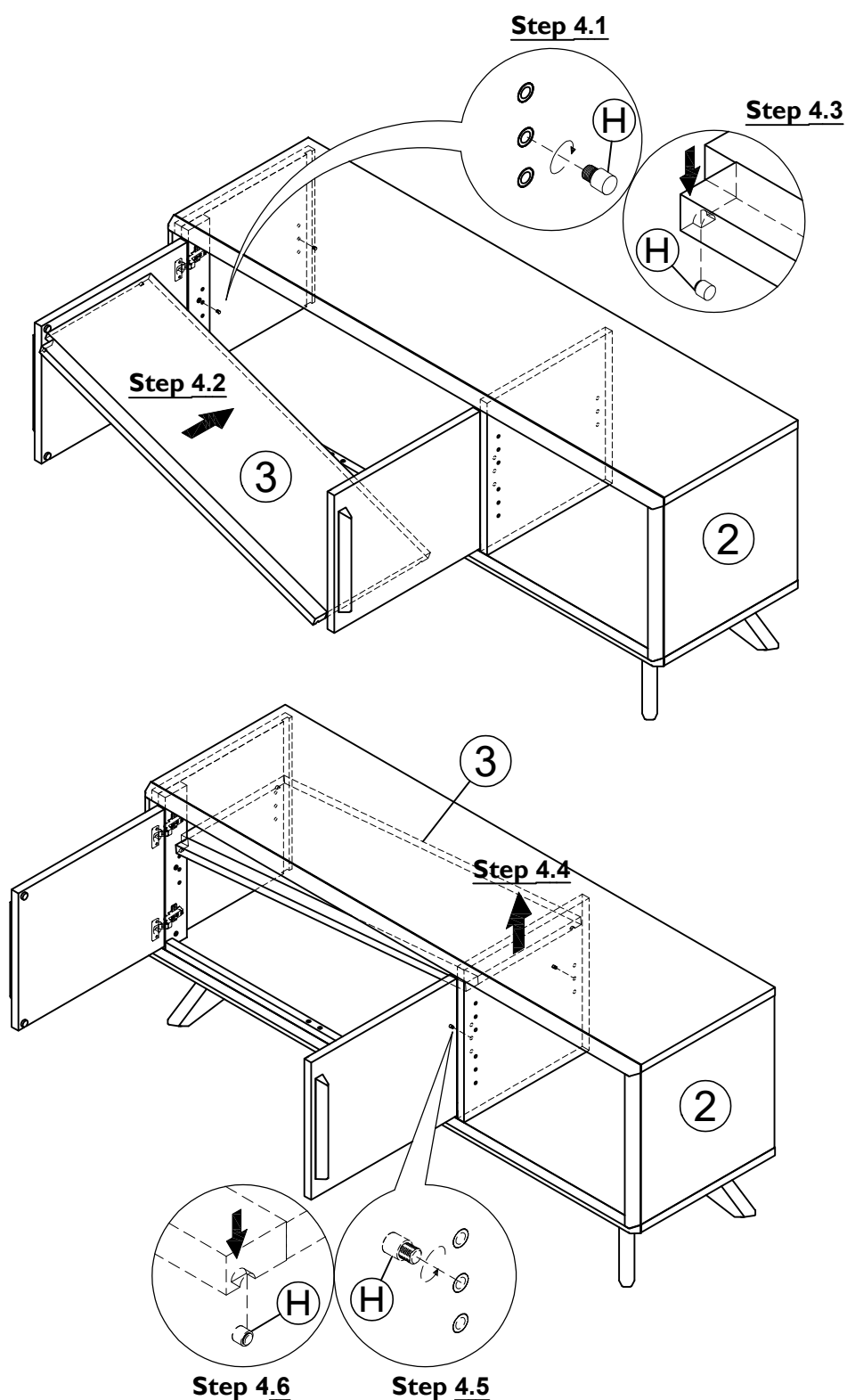

# Step By Step Assembly Instructions

## Step 5

5.1 : Screw 8x shelf pins (H) into the inset fittings inside the unit as shown.

5.2 : Slide parts (4) into the unit. Ensure the notches on shelves are facing down, then place them onto the pins of shelf pins (H) as shown.

### Step 5.2

### Step 5.1

Fitting



H x 8

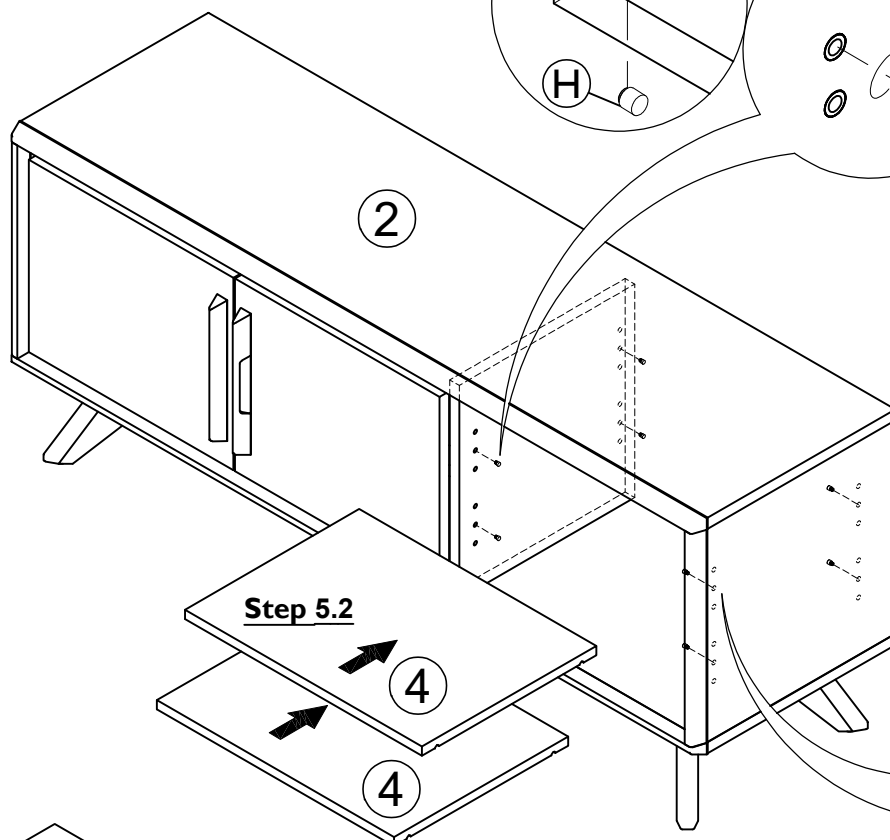
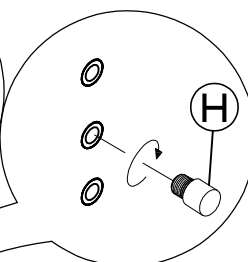
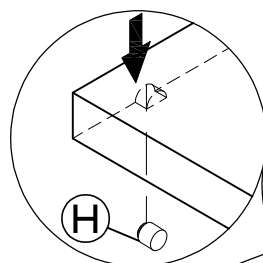

### Step 5.2

4

4

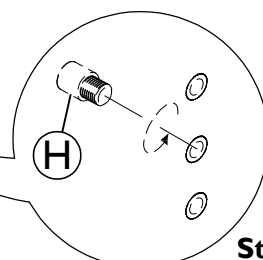

### Step 5.1

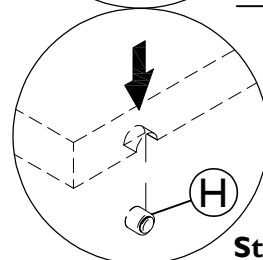

### Step 5.2

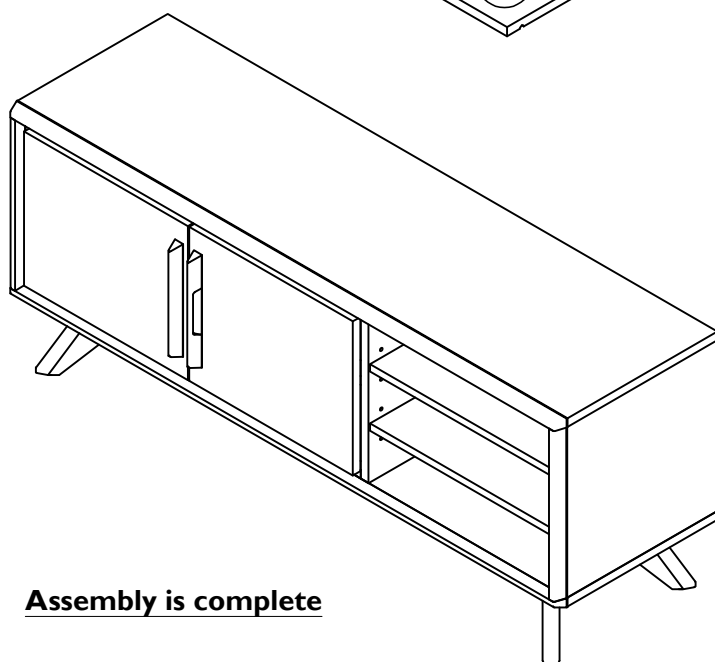

Assembly is complete

---

# HINGE ADJUSTMENT INSTRUCTIONS

---

## LATERAL ADJUSTMENT

by screw adjustment.

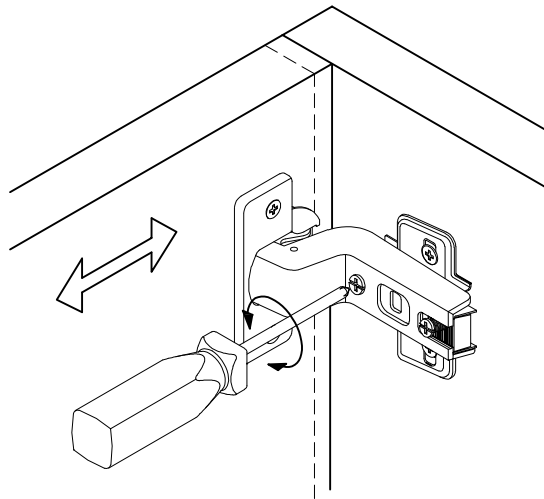

---

## FRONT-TO-BACK

by slackening and retightening the hinge-arm mounting screw.

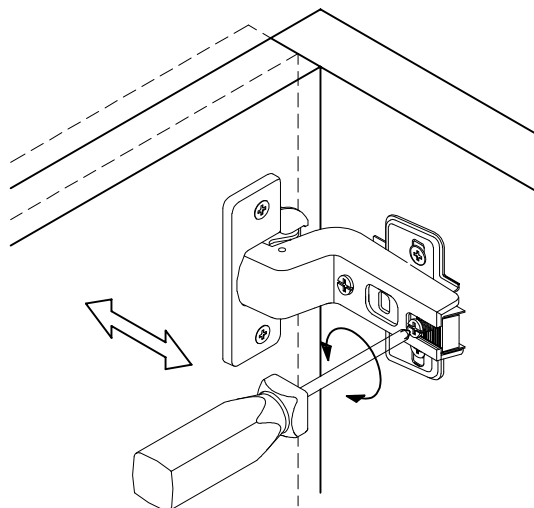

---

## VERTICAL ADJUSTMENT

via slots on mounting plate by slackening and retightening the screws on mounting plate

